

Heratherm Door Handle Replacement		
Heratherm Door Handle Replacement	Instruction	May 4, 2020

Door Handle

Remove the inner frame. Observe the 4 pads.



Unscrew the front door handle with a box spanner / socket wrench, size XX, to loose the door handle.

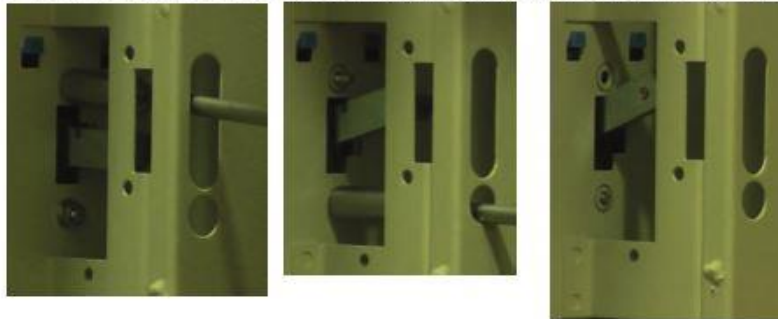

Press the handle sub-assembly to the front and replace it by a new one.



Install the replacement front door handle in the reverse order.

After installation please check the position of the front door and function of the closing hook that it closes perfectly.

Handle Cover:

Press the clips in the inner door und grip the door handle cover from below and pull it away.



Install the replacement front door cover in the reverse order.